

ORDER FORM

<p>Invoicing Details</p> <p>Company name: _____</p> <p>Delivery date required: ___/___/___</p> <p>Delivery Address: _____</p> <p>P.Code: _____ Town: _____</p> <p>Tel.: _____ Fax: _____</p> <p># Order: _____ Date of the Order: ___/___/___</p>	<p>Shipping Details</p> <p>Ship to: _____</p> <p>_____</p> <p style="text-align: center;">CUSTOMER STAMP AND SIGNATURE</p>
--	--

Pro Medicare srl grants **24 months** warranty on production defects from the date of the first put into service and **12 months** on covers and components subjected to wearing. Warranty is void if the product is used in any other way than stated in the Instruction Manual.

Note: Any request for variation in dimensions, materials and type compared to the standard does not have CE marking, therefore the professional user becomes the manufacturer and has the obligation to draw up the technical documentation of the device.

Images are purely illustrative and may not fully reflect reality.

- Standard Configuration**
- Frame Adacta Liga Light anodised satin
 - Fixed folding down back posts
 - Reclining mechanism by predetermined plate w/pin **3°,9°,15°,22°**
 - Continuous Tilt in Space by drive lever from **2° up to 35° (from 6° up to 39°)**¹
¹Tilt in space can be up-graded of 4° with an increment of the starting position of the frame by operating on the positioning holes of the caster fork
 - Adjustment of the seat depth
 - Height adjustment: High (49 cm from the floor)/low (**43 cm from the floor**)*
*(with 300mm and 500mm wheels only)
 - Detachable footplates with **90° fixed knee angle**
 - Fixed Anti-tip system
 - Wheels Kit with brake
 - Rigid wooden seat base covered leather flex
 - Multi-Adjustable padded hip guides
 - Multi-Adjustable padded arm supports
 - Versa Inserto Trunk/Pelvis positioning system
 - Capitis Headrest
 - Fixatis Pelvic Belt





◊ = Standard ○ = Optional without up-charge □ = Optional with up-charge
 * If a selection is not made, the product will be delivered in its standard configuration

Frame Color	Frame Type	Frame Size (Outside tubes Width x Depth cm)			
◊ Turquoise ○ Pink	◊ Rigid ○ Folding	○ US (30x38)	○ XXS (35x38)	○ XS (35x42)	○ XS0 (38x42)
□ Pre-assembly of postural components (collars for flat base, backrest attachments, headrest hardware)					
Knee Angle		◊ 90° ○ 75° □ elevating			
Castors		◊ 150mm (6") poly grey ○ black ○ 175mm (7") poly ○ grey ○ black			
Posterior Wheels (height 43 cm from seat to the floor with 300 mm and 500 mm wheels; height 47 cm from seat to the floor with 600 mm wheels)					
◊ 300mm (12") poly grey with parking brake lever					
○ 300mm (12") poly black with parking brake lever					
○ 300mm (12") pneumatic grey with parking brake lever					
□ 300mm (12") poly black with drum brake					
□ 300mm (12") poly grey with drum brake					
□ 300mm (12") pneumatic grey with drum brake					
□ 300mm (12") poly black with drum brake and parking brake lever					
□ 300mm (12") poly grey with drum brake and parking brake lever					
□ 300mm (12") pneumatic grey with drum brake and parking brake lever					
□ 400mm (16") poly black with parking brake lever (only 45 cm height)					
□ 400mm (16") poly black with drum brake (only 45 cm height)					
□ 400mm (16") poly black with drum brake and parking brake lever (only 45 cm height)					
□ 500mm (20") poly grey without handrim with parking brake lever					□ handrim for 500mm (20") wheels
□ 500mm (20") pneumatic grey without handrim with parking brake lever					
□ 500mm (20") pneumatic grey with handrim with drum brake					
□ 500mm (20") pneumatic grey with handrim with drum brake and parking brake lever					
□ 600mm (24") pneumatic grey with handrim with parking brake lever (not available on size US)					
<i>(Note: The tilt in space is reduced to 20°, height from the floor 47 cm)</i>					

Anti-tip system	<input checked="" type="checkbox"/> fixed	
	<input type="checkbox"/> detachable	
Tilt in space	<input checked="" type="checkbox"/> with lever	<input type="checkbox"/> with pedal
Pelvis Positioning System		
<input checked="" type="checkbox"/> Inserto Seat Basico	<input type="checkbox"/> Inserto Seat Mediano	<input type="checkbox"/> Inserto Seat Domino
<input type="checkbox"/> Waterproof seat cover with elastic band		
Trunk Positioning System		
<input checked="" type="checkbox"/> Inserto Back Effecto Lato	<input type="checkbox"/> Inserto Back Supporto	
Lumbar pushing insert <input checked="" type="checkbox"/> RH <input checked="" type="checkbox"/> LH	Lumbar containment insert <input type="checkbox"/> RH <input type="checkbox"/> LH	
Backpost (Note: Push handles height 63 cm)		
<input checked="" type="checkbox"/> Kit for fixed push handles		
<input type="checkbox"/> Kit for push handles adjustable in height by pin (max adjustment 10 cm with 2.5 cm gap)		
<input type="checkbox"/> Kit for telescopic push handles with lever block (max adjustment 10 cm)		
<input type="checkbox"/> Kit for angle adjustable single handlebar for rigid frame		
<input type="checkbox"/> Kit for telescopic and angle adjustable single handlebar		
<input type="checkbox"/> Kit for angle adjustable handlebar for folding frame		
<input type="checkbox"/> Quick-release pins for easier backrest inclination (not valid for crash test)		

Accessories

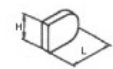
Thoracic Supports for Inserto Back Supporto *Please, indicate the type, the shapes and the size desired

Type of Bracket	Shape of the Pad							
Fixed	Flat		→	cm	<input type="checkbox"/> size 1	<input type="checkbox"/> size 2	<input type="checkbox"/> size 3	<input type="checkbox"/> size 4
<input type="checkbox"/> RH <input type="checkbox"/> LH	<input type="checkbox"/> RH <input type="checkbox"/> LH			H	6	8	10	12
Swing-Away	Contoured		→	L	6,5	8,5	10,5	13,5
<input type="checkbox"/> RH <input type="checkbox"/> LH	<input type="checkbox"/> RH <input type="checkbox"/> LH			cm	<input type="checkbox"/> size 1	<input type="checkbox"/> size 2	<input type="checkbox"/> size 3	
				H	6	8	10	
				L	10,5	12,5	14,5	

Thoracic Supports for Inserto Back Effecto Lato *Please, indicate the type, the shape of the brackets, the pad and the size desired

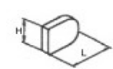
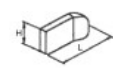
Type of Bracket	Shape of the Pad							
Fixed	Flat		→	cm	<input type="checkbox"/> size 1	<input type="checkbox"/> size 2	<input type="checkbox"/> size 3	<input type="checkbox"/> size 4
<input type="checkbox"/> RH <input type="checkbox"/> LH	<input type="checkbox"/> RH <input type="checkbox"/> LH			H	6	8	10	12
Swing-Away	Contoured		→	L	8	10	12	15
<input type="checkbox"/> RH <input type="checkbox"/> LH	<input type="checkbox"/> RH <input type="checkbox"/> LH			cm	<input type="checkbox"/> size 1	<input type="checkbox"/> size 2	<input type="checkbox"/> size 3	
Detachable	Bracket shape (for the selection see TECHNICAL INFORMATION)			H	6	8	10	
<input type="checkbox"/> dx <input type="checkbox"/> sx	type A: <input type="checkbox"/> RH <input type="checkbox"/> LH type B: <input type="checkbox"/> RH <input type="checkbox"/> LH			L	12	14	16	

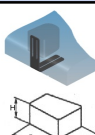
Pedal for barriers <input type="checkbox"/> RH <input type="checkbox"/> LH	Abductor wedge only with rigid seat base																	
<input type="checkbox"/> Vehicle Transportation Kit* <small>(Only frame height 43cm and with 300mm and 500mm posterior wheels) *according to the ISO 7176-19 standard: do not use the wheelchair as a seat in the vehicle if the weight of the user is lower than 22 kg</small>		<table border="1"> <tr> <td>cm</td> <td><input type="checkbox"/> S</td> <td><input type="checkbox"/> M</td> <td><input type="checkbox"/> removable with lever</td> </tr> <tr> <td>H</td> <td>7.5</td> <td>9</td> <td></td> </tr> <tr> <td>D</td> <td>9</td> <td>10</td> <td><input type="checkbox"/> removable with mounting block</td> </tr> <tr> <td>L</td> <td>7.5</td> <td>9</td> <td></td> </tr> </table>	cm	<input type="checkbox"/> S	<input type="checkbox"/> M	<input type="checkbox"/> removable with lever	H	7.5	9		D	9	10	<input type="checkbox"/> removable with mounting block	L	7.5	9	
cm	<input type="checkbox"/> S	<input type="checkbox"/> M	<input type="checkbox"/> removable with lever															
H	7.5	9																
D	9	10	<input type="checkbox"/> removable with mounting block															
L	7.5	9																
Lower limb accessories	<p><input type="checkbox"/> Separate Calf Supports swing-away</p> <p><input type="checkbox"/> Padded Calf Strap</p> <p>Cover for legrest tube <input type="checkbox"/> RH <input type="checkbox"/> LH</p> <p>Cover for Knee Angle joint <input type="checkbox"/> RH <input type="checkbox"/> LH</p> <p><input type="checkbox"/> Padding and cover of footplate in leatherette</p>																	
Capitis Headrest Comfort size:	<p><input type="checkbox"/> Small <input checked="" type="checkbox"/> Medium <input type="checkbox"/> Large</p>																	
Fixatis Pelvic belt 2P.2A. with squeeze plastic buckle size:	<p><input type="checkbox"/> XS <input checked="" type="checkbox"/> S <input type="checkbox"/> M</p>																	
Fixatis Dynamic Butterfly Harness	<p><input type="checkbox"/> XS <input type="checkbox"/> S <input type="checkbox"/> M</p>																	
	<p>Tray</p> <p><input type="checkbox"/> Rectangular Wooden Tray w/lateral flip hardware</p> <p><input type="checkbox"/> Rectangular Wooden Tray w/detachable hardware</p> <p><input type="checkbox"/> Padding for Tray</p>																	

- **Kit of ABS laterals multi-adjustable, detachable and w/multi-adjustable arm support**
in width and depth with 2.5 cm gap

make a selection:

- small arm support (from US to XS0)
(dimensions: 5 cm x 25 cm)
- large arm support (from XS1 to XL)
(dimensions: 6 cm x 30 cm)

make a selection:

- short vertical bar (from 22 cm to 31 cm*)
- long vertical bar (from 29 cm to 38 cm*)
- * distance from armrest to the seat rail

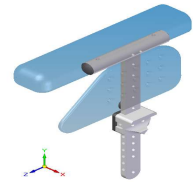

- **Multi-adjustable and detachable hips and arms positioning kit**

- **pelvis** (width, depth, height, adduction/abduction adjustable)
- **arm support** (width, depth, height, inclination, intra/extra-rotation adjustable)

For independent adjustments referring to the width the gap is 3 cm

The armrests and the hip guides are assembled on the frames as the following indications without possibilities to be modified

- **small** (from frame size US up to XXS) (armrests dimensions: 8 cm x 22 cm) (hips guide dimensions: 25 cm x 10 cm with slot of 5 cm)
- **large** (from frame size XS to XS0) (armrests dimensions: 10 cm x 30 cm) (hips guide dimensions: 30 cm x 12 cm with slot of 7.5 cm)

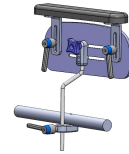

Sizes of the arm supports and hip guides. Note: The components cannot be interchangeable

Linear Hip Guides						ABS Lateral					
	cm	US	XXS	XS	XS0		cm	US	XXS	XS	XS0
	H	10	10	10	10		H	11	11	11	13
	L	25	25	30	30		L	24	24	24	28
Flat Arm Support						Armrest of the ABS Lateral kit					
	cm	US	XXS	XS	XS0		cm	US	XXS	XS	XS0
	H	10	10	10	10		H	5	5	5	5
	L	25	25	30	30		L	27	27	27	33

Technical Information

Titti Size	Maximum Load (kg)	Frame Weight (kg)	Pivot Width (cm)	Maximum overall dimensions in width/length (90° knee angle and footrest positioned forwards) Values expressed in cm							
				standard 300mm wheels	300mm wheels w/drum brake	standard 400mm wheels	400mm wheels w/drum brake	standard 500mm wheels	500mm wheels w/drum brake	600mm wheels	
				US	Rigid	50	14.1	69	48/96	49/96	50/99
	Folding	50	14.9								
XXS	Rigid	50	14.4	69	53/96	54/96	55/99	58/99	55/101	58/101	55/104
		Folding	50								
XS	Rigid	50	14.7	72	53/99	54/99	55/100	58/100	55/102	58/102	55/107
		Folding	50								
XS0	Rigid	50	15.4	75	56/99	57/99	58/100	61/100	58/102	61/102	58/107
		Folding	50								

Note: Frame weight only with wheels, knee angle and footrest as standard configuration. The length dimensions, referred to the average values, are subjected to variations due to the displacement of the wheel plates. The values reported are intended for the standard configuration.

Titti Size	User Parameters		Frame Depth Adjustments (cm)	Cushion Size (IW x D) (cm)	Supporto Back sizes (cm)				Effetto Lato Back sizes (cm)			
	Pelvis Width (cm)	Seat Depth (cm)			Backrest	Height	Shell Width	Trunk Width	Backrest	Height	Shell Width	Trunk Width
US	20-30	28-38	da 36 a 44	30x38	3033	33	27	17-23	3033	33	30	w/bracket A 18-28 w/bracket B 13-23
XXS	26-36	28-38	da 36 a 44	36x38	3336	36	30	20-26	3338	38	33	w/bracket A 21-31 w/bracket B 16-26
XS	26-36	32-42	da 40 a 48	36x42	3640	40	33	23-29	3642	42	36	w/bracket A 24-34 w/bracket B 19-29
XS0	29-39	34-44	da 40 a 48	39x45	3944	44	36	26-34	3945	45	39	w/bracket A 27-37 w/bracket B 22-32